

# Fall Detector™

## User Instructions (Europe)



Activity indicator

Manual trigger button

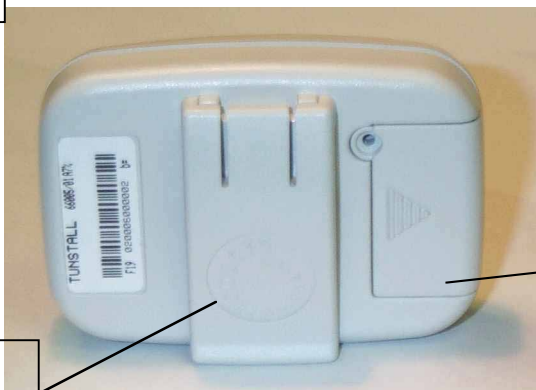

Belt / clothing clip

Battery Cover

Your **fall detector**<sup>™</sup> is a battery operated device containing a microprocessor, detector and a radio transmitter. It will automatically trigger an alarm call on your community alarm system if it detects that you have fallen. You can also use it to manually raise an alarm call.

### **Wearing the fall detector**

- Clip the **fall detector** to your belt or clothing in the upright position shown in the drawing.

It needs to be in the upright position to reduce the possibility of false activation.

Note: An optional Belt and Holster is available (Part Number D6609001C).

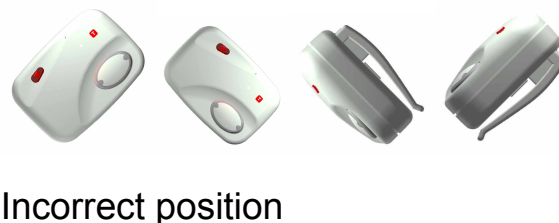
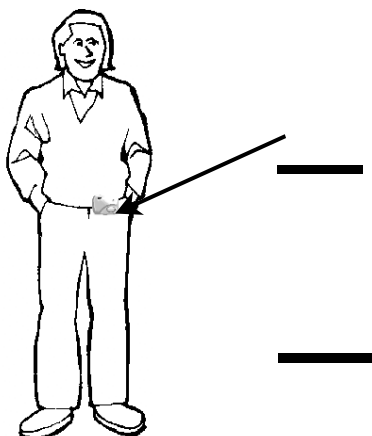

## Automatic fall detection

- Green light and two "beeps" indicates that the **fall detector** has been activated.
- The **fall detector** will then monitor for between 6 and 15 seconds to verify if there could have been a fall. The green light will flash while it does this.
  - If the detector has decided that there is a fall, then a red light and four "beeps" indicates that the **fall detector** is about to trigger an alarm call (because it has detected an impact and has not been upright for between 6 and 15 seconds).
  - If the detector has decided that it was activated by error then the green flashing light will stop after between 6 to 15 Seconds and the unit will revert to normal again.
- The **fall detector** also features a manual button, which can be used at any time to raise a call for help if required.

## Manual operation

- Press the button on the fall detector to raise a manual alarm call.
  - The ***fall detector*** will "beep" and a red light indicates the ***fall detector*** is triggering an alarm call.
  - If the red light flashes on and off, the ***fall detector*** is still triggering an alarm call, but is also indicating to you that the battery needs to be replaced.

- Remember, the **fall detector** will only detect you falling if you are wearing it.
- The **fall detector** must be worn at or above the waist, where it will detect the maximum number of falls.



- When removing the **fall detector**, handle carefully to avoid false calls, place it on an even surface in the upright position and preferably in the stand provided.
- If the **fall detector** does wake up and beep when you know you have not fallen, you can prevent it raising an alarm by ensuring that it is returned to an upright position.
- It is not recommended that you wear the **fall detector** whilst in bed, as normal movement in bed will cause the fall detector to trigger.

---

## **Battery Replacement**

From time to time the battery will need replacing, you will know this because somebody from your monitoring service (if you have one) may inform you, or you may see the red light flashing rather than staying on continuously when a manual alarm call is made.

- The unit automatically tests the battery several times within each 24 hour period. It is able to automatically generate an alarm call when low battery is detected.
- If it is necessary for you to change the battery, the fall detector uses a 6 volt Duracell PX28L battery.
- To access the battery, remove the battery cover screw and then the battery cover by sliding it in the direction of the arrow.
- After a year the battery should be replaced. Contact your provider for a replacement. In many cases your provider will change the battery for you. On the back of this user guide is a handy table to

help you remember when the battery should be changed.

- Remove battery and replace it with the new battery, remember to observe the correct orientation. When the battery is first placed in the unit an automatic test call will be generated (no lights will show and no buzzer will sound).
- Replace the sliding cover and the screw. Test the fall detector by making a manual call. Inform the operator that you are making a battery test call.
- If the device fails to make a test call then check the orientation of the battery. If this is correct then contact your supplier.

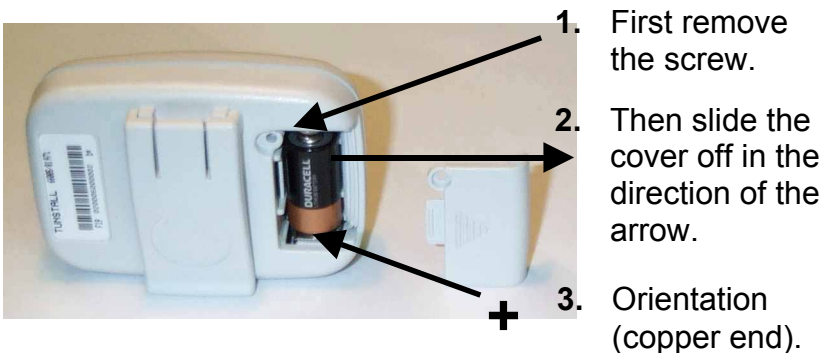

Li

Do not dispose of the old battery in the bin, please return it to Tunstall (c/o Service Centre) at the address shown overleaf.

---

## Care of the *fall detector*

- Avoid getting the *fall detector* wet (if it does then dry it quickly and make a manual test call to confirm it is working correctly).
- If required, the *fall detector* may be cleaned periodically with a damp cloth and mild detergent.
- It is recommended that you test the *fall detector* once a month:
  - Make a manual test call.
  - Start with the *fall detector* vertical. Place the *fall detector* horizontal and then tap within 3 seconds after placing horizontal. After 5 Seconds the *fall detector* should beep and the green light start to flash. If you put the unit quickly back upright (in its stand, for instance), the alarm call will not be raised.



---

## Notices

This product constitutes a class 2.7 device. It is marked with the CE mark, a notified body number and the 'alert' symbol. These marks have been affixed to demonstrate compliance with the Directive 1999/5/EEC (RTTE Directive).

The 433.15MHz product is intended for use in the following countries:

Germany, Holland, Spain, Denmark, Italy, Sweden, Belgium.

The 469.99MHz product is intended for use only in Germany.

The 173.225MHz product is intended for use in UK, Eire and New Zealand.

The 869.2125MHz product is intended for use in Europe.



All the reassurance you need

**Tunstall**



01RTTE013B

DECLARATION OF CONFORMITY WITH THE REQUIREMENTS  
OF EU COUNCIL DIRECTIVE 1999/5/EC.

**EQUIPMENT** : Fall Detector 66000/01 (UK 173.225MHz Grey Variant)  
Fall Detector 66000/02 (UK 173.225MHz Black Variant)  
Fall Detector 66005/01 (Euro 433.15MHz Grey Variant)  
Fall Detector 66005/02 (Euro 433.15MHz Black Variant)  
Fall Detector 66008/01 (Euro 469.99MHz Grey Variant)  
Fall Detector 66008/02 (Euro 469.99MHz Black Variant)  
Fall Detector 67005/49 (Euro 869.2125MHz Grey Variant)

**STANDARDS** : EMC : EN50130-4:1995  
LVD : EN60950:92 incorporating amendments 1,2, 3, 4 and 11  
Radio : EN300-220-3:2000

**ASSOCIATED DOCUMENTS** : Summary Information 01RTTE014B

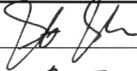
The equipment identified above conforms to the essential requirements of Council Directive 1999/5/EC.	
<i>The essential radio test suites have also been performed</i>	
Signed	
Date	28 <sup>th</sup> January 2004
Position	Technical Director

Tunstall Telecom Limited, Whitley Lodge, Whitley Bridge, Yorkshire DN14 0HR

Telephone: 01977 661234 Facsimile: 01977 660562

Internet: [www.tunstallgroup.com](http://www.tunstallgroup.com)



## Battery Replacement Guide

Battery Inserted Date			Battery Replacement Date		
<i>Day</i>	<i>Month</i>	<i>Year</i>	<i>Day</i>	<i>Month</i>	<i>Year</i>

Remember to change the battery once a year.

**Manufactured By**

Tunstall Telecom Ltd.  
Whitley Lodge  
Whitley Bridge  
Yorkshire  
DN14 OHR

Tel : 01977 661234  
Fax: 01977 662963  
[www.tunstallgroup.com](http://www.tunstallgroup.com)

**Supplied By**

